

DATE	REV	ECN	APP'D. BY
4-17-15	A0	-	TRM
2-22-16	A1	10555	TRM

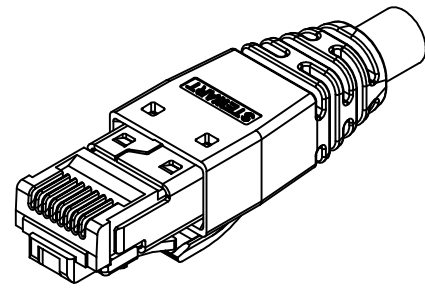

ISOMETRIC VIEW OF TERMINATED PLUG

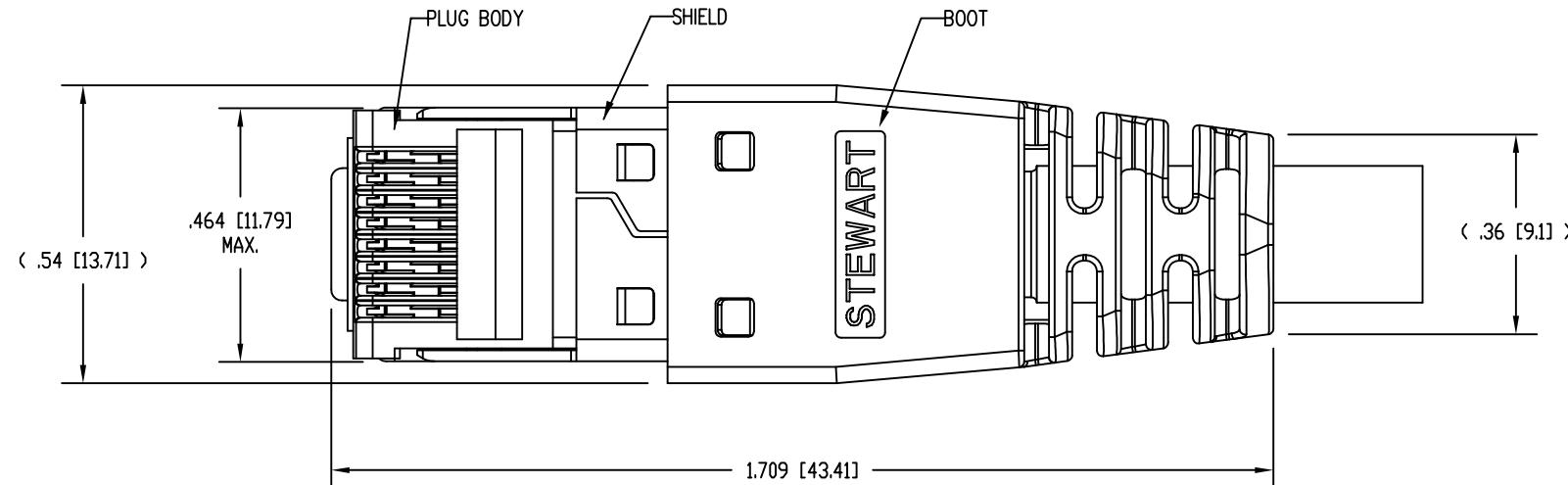

NOTES:

- PLUG KIT CONSISTS OF:  
 PRE-INSERTED PLUG BODY - 39200-320  
 LOAD BAR - 39200-899  
 BOOT - 39200-838  
 WIRE ALIGNER - 39100-864  
 SHIELD - 39200-509
- MATERIALS:  
 PLUG BODY: CLEAR POLYCARBONATE, UL 94-V0  
 BOOT: BLACK POLYCARBONATE, UL 94-V0  
 WIRE ALIGNER AND LOAD BAR: CLEAR POLYCARBONATE, UL 94-V0  
 CONTACTS: COPPER ALLOY, SELECTIVE GOLD PLATING  
 SHIELD: COPPER ALLOY, NICKEL PLATE
- FOR PRODUCT SPECIFICATION SEE PRO26-01.
- CONTACTS TERMINATE SOLID OR STRANDED CONDUCTORS BETWEEN .042 [1.07] TO .048 [1.22] OUTSIDE DIAMETER OF INSULATION.
- CRIMP IS FOR CABLES WITH OUTSIDE NOMINAL DIAMETERS OF .232 [5.90] TO .248 [6.30].
- INDIVIDUALLY BAGGED PLUG KITS (1 EACH PLUG BODY, LOAD BAR, WIRE ALIGNER, AND BOOT) PACKAGED 25 PER BOX.
- DIMENSIONS AND TOLERANCES COMPLY WITH TIA-1096 STANDARD FORMERLY FCC/CFR 47, PART 68.
- CONTACT HEIGHT BEFORE TERMINATION.  
 AFTER TERMINATION, THE CONTACT HEIGHT IS .237 [6.02] ±.005 [0.13].
- PRODUCT DESIGNED FOR CATEGORY 6 AND 6A APPLICATIONS.

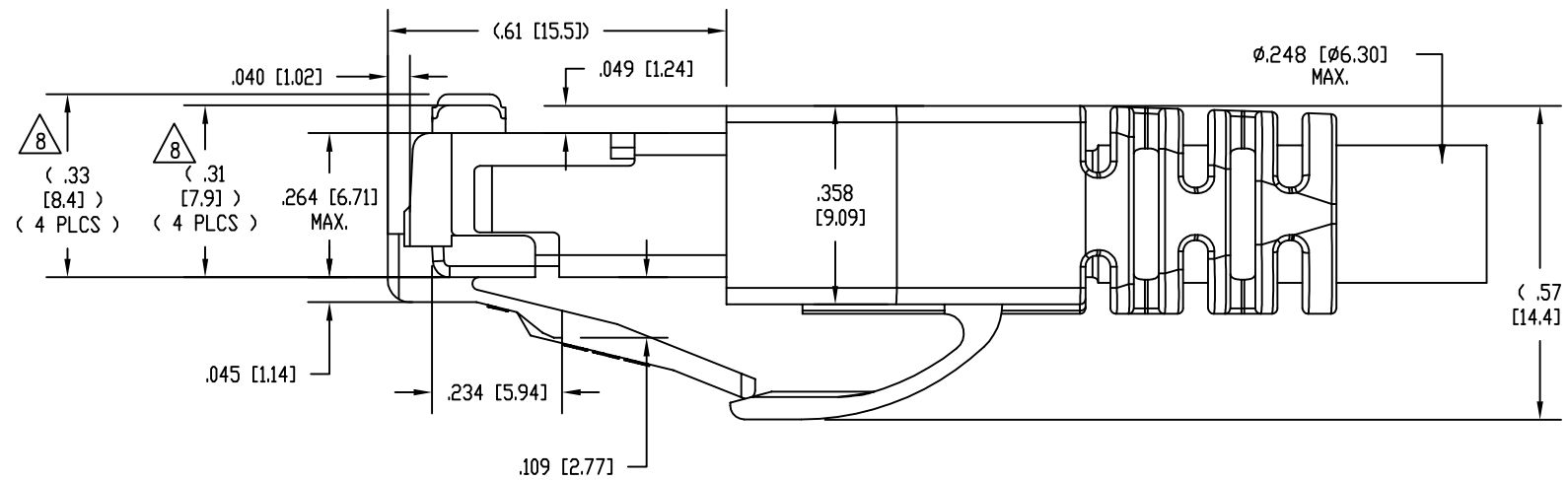
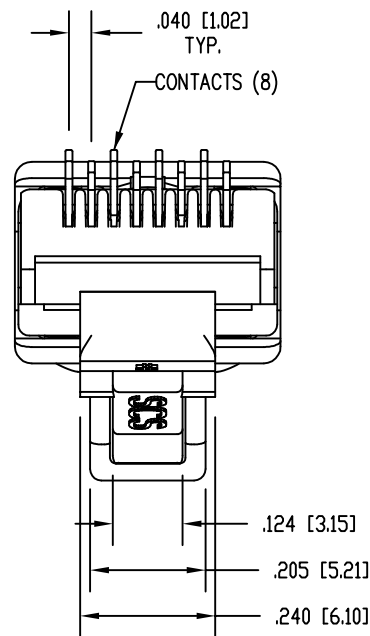

BAGGED $\triangle 6$	50 MICRO-INCHES [0.76um]	SS-39200-043
PACKAGING	CONTACT PLATING IN MATING AREA	PART NUMBER

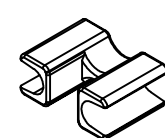

WIRE ALIGNER  
39100-864

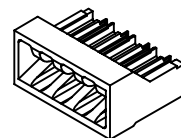

LOAD BAR  
39200-899

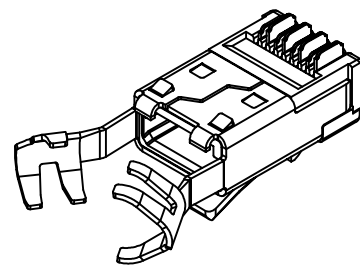

PRE-INSERTED PLUG BODY 39200-320 WITH SHIELD 39200-509

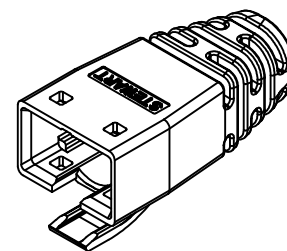

BOOT  
39200-838



THIRD ANGLE PROJECTION

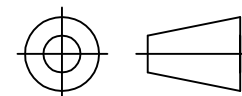

1118 Susquehanna Trail South  
Glen Rock, PA 17327-9199  
(717) 235-7512

<http://www.stewartconnector.com>

DO NOT SCALE DRAWING  
DRAWING IS SUBJECT TO CHANGE WITHOUT NOTICE

TITLE: 8 CONDUCTOR, 8 POSITION SHIELDED PLUG, WITH BOOT, LOAD BAR, AND WIRE ALIGNER, .248 MAX CABLE

DIMENSIONS: INCHES [METRIC]  
UNLESS OTHERWISE SPECIFIED TOLERANCES ARE ±.005 [0.13] ANGLES ARE ± 1°

THIS DRAWING AND THE SUBJECT MATTER SHOWN THEREON ARE CONFIDENTIAL AND THE PROPRIETARY PROPERTY OF STEWART CONNECTOR AND SHALL NOT BE REPRODUCED, COPIED, OR USED IN ANY MANNER WITHOUT PRIOR WRITTEN CONSENT OF STEWART CONNECTOR. ONE OR MORE U.S. PATENTS MAY APPLY TO THIS PRODUCT. FOR DETAILS, PLEASE VISIT: [HTTP://BELFUSE.COM/STEWART/STEWART\\_PATENTS/](http://BELFUSE.COM/STEWART/STEWART_PATENTS/)

DRN BY:	SMN	DATE	4-17-15
APPD BY:	TRM	DATE	4-17-15
DWG NO.	CT390128	REV.	A1

SHEET NO. 1 OF 1