

THIS DRAWING AND THE SUBJECT MATTER SHOWN THEREON ARE CONFIDENTIAL AND THE PROPERTY OF BEL/STEWART/TRP CONNECTOR AND SHALL NOT BE REPRODUCED, COPIED, OR USED IN ANY MANNER WITHOUT THE WRITTEN CONSENT OF TRP CONNECTOR.

PRODUCT MAY BE PROTECTED BY ONE OR MORE OF THE FOLLOWING US PATENTS:  
5736910 5939955 6425781 6428361 6554638 6840817 7123117  
7429195 7717749 7808751 6217391 6149050 7924130

REVISIONS				
REV	DATE	DESCRIPTION	BY	APPV
C	07JAN2015	COMPANY LOGO CHANGE	RL	TY

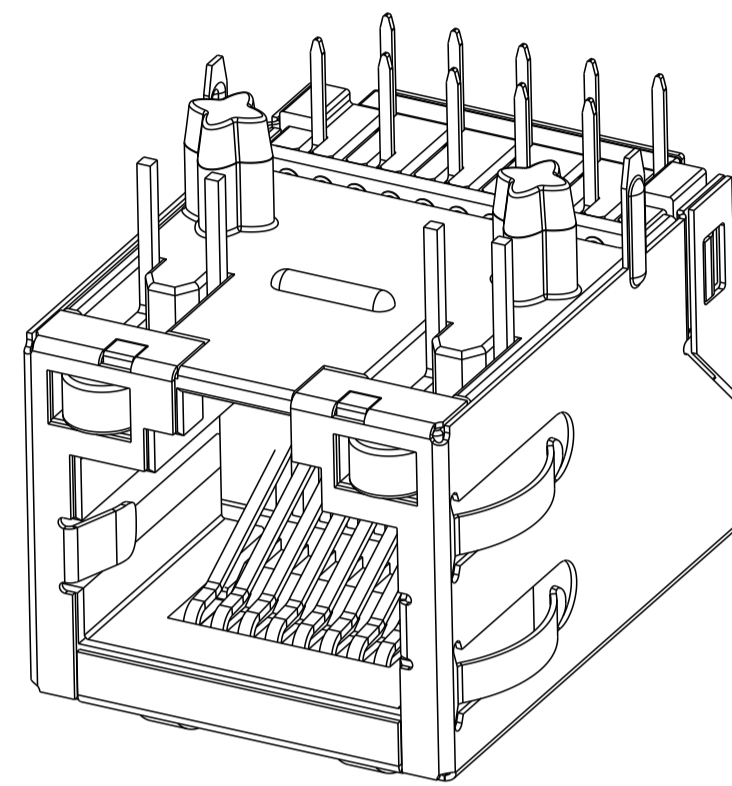
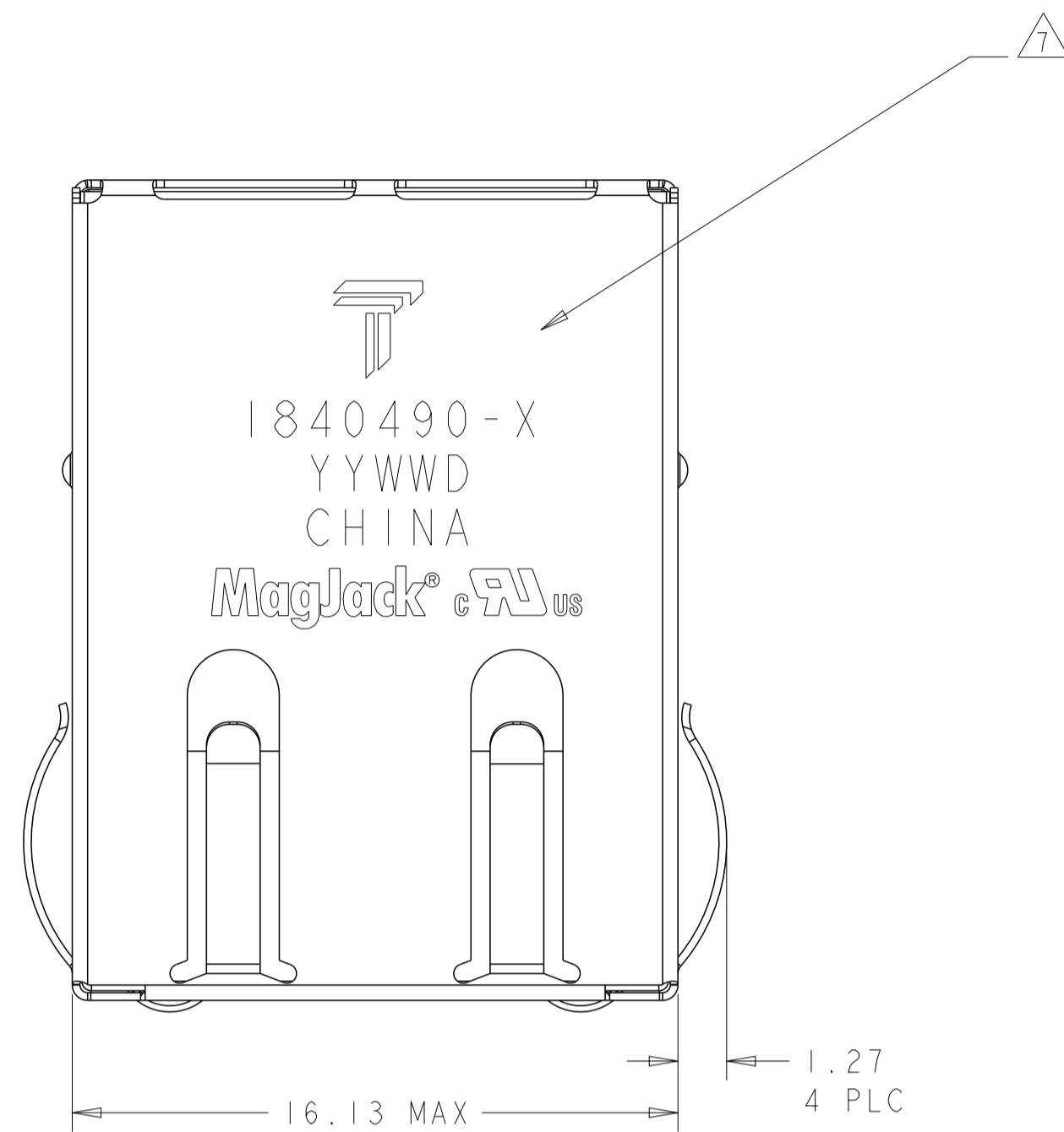

SCALE 4:1

1. MATERIALS
- HOUSING: THERMOPLASTIC, FLAMMABILITY RATING UL 94V-0.
  - SHIELD: BRASS C26800 0.20mm THICK, PREPLATED WITH 0.76um MIN SEMI-BRIGHT NICKEL. SOLDER TABS POST DIPPED WITH 2.54um MIN SAC SOLDER.
  - CONTACTS: PHOSPHOR BRONZE 0.46mm X 0.30mm, PHOSPHOR BRONZE, 1.27um MIN NICKEL UNDERPLATE, WITH 1.27um MIN GOLD PLATING AT MATING INTERFACE AND 2.54um MIN MATTE TIN ON SOLDER TAILS.
  - SOLDER TAILS: 0.25mm THICK, PHOSPHOR BRONZE, 1.27um MIN OVERALL NICKEL UNDERPLATE, 3um TIN PLATE
  - LIGHT EMITTING DIODE (LED): DIFFUSED EPOXY LENS, 0.5mm X 0.5mm CARBON STEEL WIREFRAME LEADS PREPLATED WITH 2.03um MIN. SILVER PLATE OVER 1.02um MIN. NICKEL OVER 1.02um MIN. COPPER UNDERPLATE; LEADS POST-PLATED WITH 3.05um MIN. MATTE TIN AND/OR SAC SOLDER DIP OR PURE TIN SOLDER DIP

2. RJ45 JACK CAVITY CONFORMS TO FCC RULES AND REGULATIONS PART 68 SUB PART F.

3. MAGNETICS
- APPLICATION: 10/100/1000 BASE-T
  - IMPEDANCE: 100 OHMS
  - TURNS RATIO (CHIP:CABLE): 1:1 ALL FOUR PAIRS
  - OPEN CIRCUIT INDUCTANCE (OCL): 350uH MIN. @100kHz, 0.1VRMS, 8mADC BIAS FROM 0°C TO 70°C, ALL FOUR PAIRS
  - ALL FOUR PAIRS BI-DIRECTIONAL
  - PERFORMANCE @ 25°C:
    - INSERTION LOSS (IL): 1.1dB MAX. FROM 0.5MHz TO 100MHz
    - RETURN LOSS (RL): 18dB MIN FROM 0.5MHz TO 40MHz
    - 12-20LOG(f/80)dB MIN. FROM 40.1MHz TO 100MHz
    - CROSSTALK ATTENUATION: 35dB MIN. FROM 0.5MHz TO 40MHz
    - 33-20LOG(f/50)dB MIN. FROM 40.1MHz TO 100MHz
    - COMMON MODE REJECTION RATIO (CMRR): 30dB MIN. FROM 0.5MHz TO 100MHz
  - ISOLATION VOLTAGE: 2250VDC FOR 60 SECONDS WITH A RISE TIME OF 500 V/SEC

4. OPERATING TEMPERATURE: FROM 0°C TO +70°C.

5. INDICATED MAGNETIC CONNECTIONS ARE SYMMETRICAL TO SUPPORT AUTO-MDI/MDIX.

6. LEDs ARE DRIVEN WITH CONSTANT CURRENT AT APPROX 20mA

LED COLOR: DOMINATE WAVELENGTH ( $\lambda_D$ ): GREEN 568 nm TYP. AT IF = 20mA  
FORWARD VOLTAGE (VF): GREEN 2.2V TYP. at IF = 20mA  
DOMINATE WAVELENGTH ( $\lambda_D$ ): YELLOW 588 nm TYP. AT IF = 20mA  
FORWARD VOLTAGE (VF): YELLOW 2.1V TYP. at IF = 20mA

7. TRP CONNECTOR LOGO, PART NUMBER, DATE CODE, COUNTRY OF ORIGIN AND AGENCY APPROVAL MARKING IN APPROXIMATE LOCATION SHOWN.  
DATE CODE: YYWW "YY" IS YEAR, "WW" IS WORK WEEK, "D" IS DAY OF WEEK, WITH SUNDAY=1.

8. THIS PART IS RECOMMENDED FOR WAVE SOLDERING PROCESS, PREHEAT TEMPERATURE IS 120°C TO 160°C, 120 SECONDS TO 180 SECONDS, PEAK WAVE SOLDERING TEMPERATURE IS 260°C MAX, 10 SECONDS MAX.

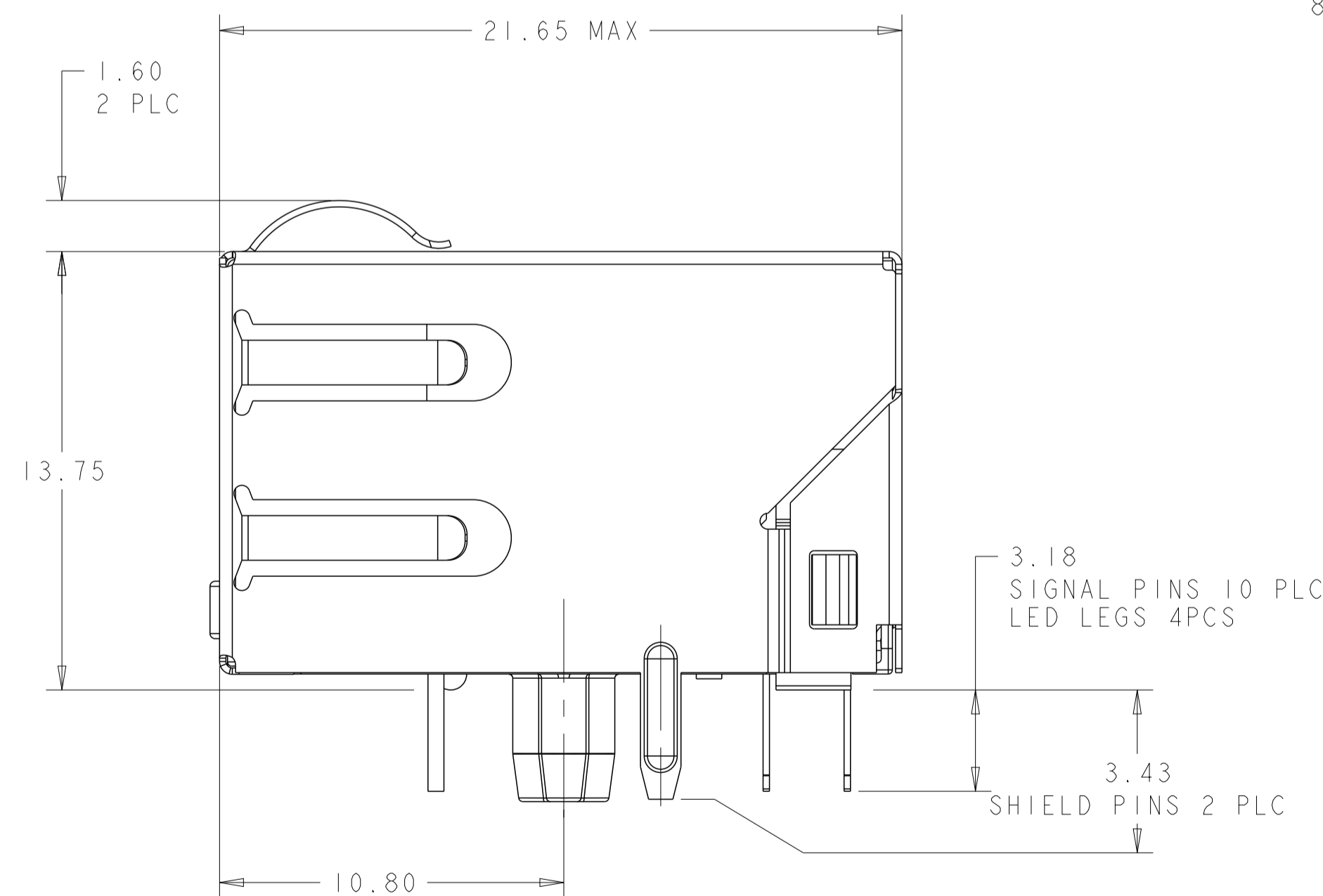
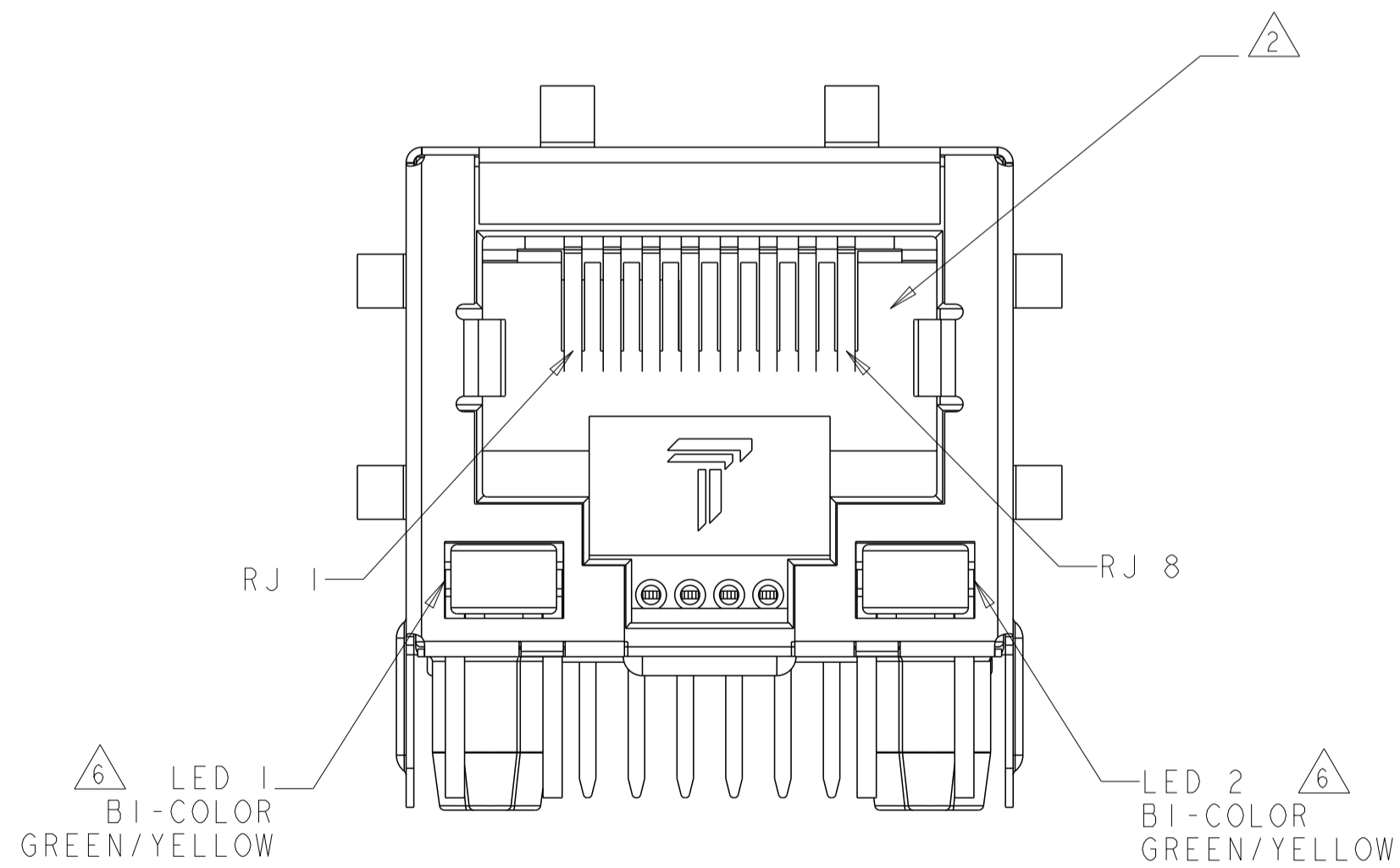

1840490-1  
PART NO.

THIS DRAWING IS A CONTROLLED DOCUMENT.		OWN: WILLIAN XIAO 28APR2010	 <b>trp</b> CONNECTOR a bel group DONGGUAN CHINA
DIMENSIONS: mm		CHK: TOWER YU 28APR2010	
TOLERANCES UNLESS OTHERWISE SPECIFIED:		APVD: HETH ZHU 28APR2010	DESC: I XI 4G17PI GIGABIT TAB DOWN W/ LED
0 PLC ±0.25	1 PLC ±0.25	MODEL NAME: MAGJACK	SIZE: A1
2 PLC ±0.25	3 PLC ±	PRODUCT SPEC: SINGLE Non-PoE	CAGE CODE: C=1840490
4 PLC ±	ANGLES ±	PRODUCT SPEC: 108-104004	RESTRICTED TO: -
APPLICATION SPEC		CUSTOMER DRAWING	SCALE: 4:1 SHEET 1 OF 2 REV C

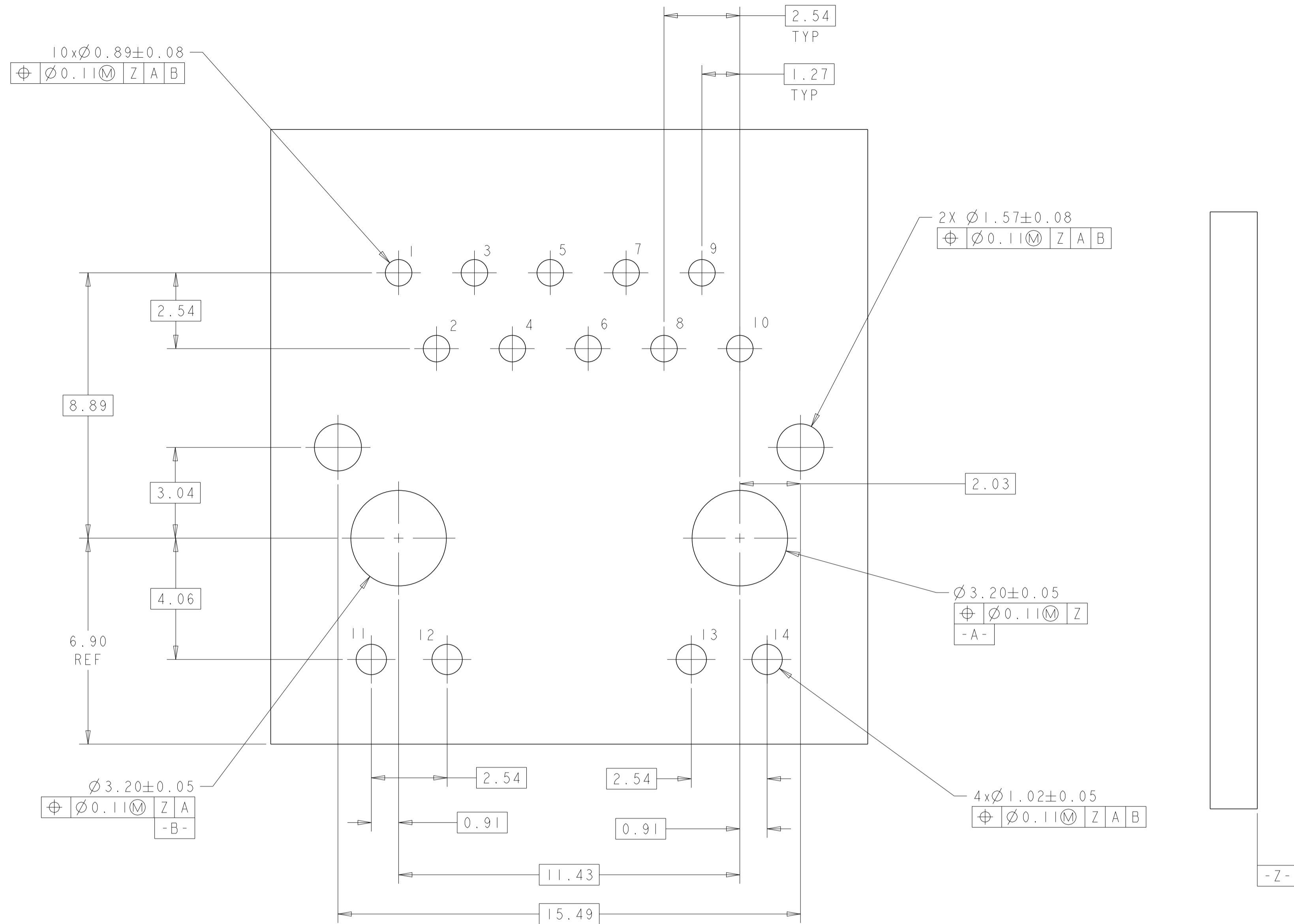

SUGGESTED PCB LAYOUT COMPONENT SIDE

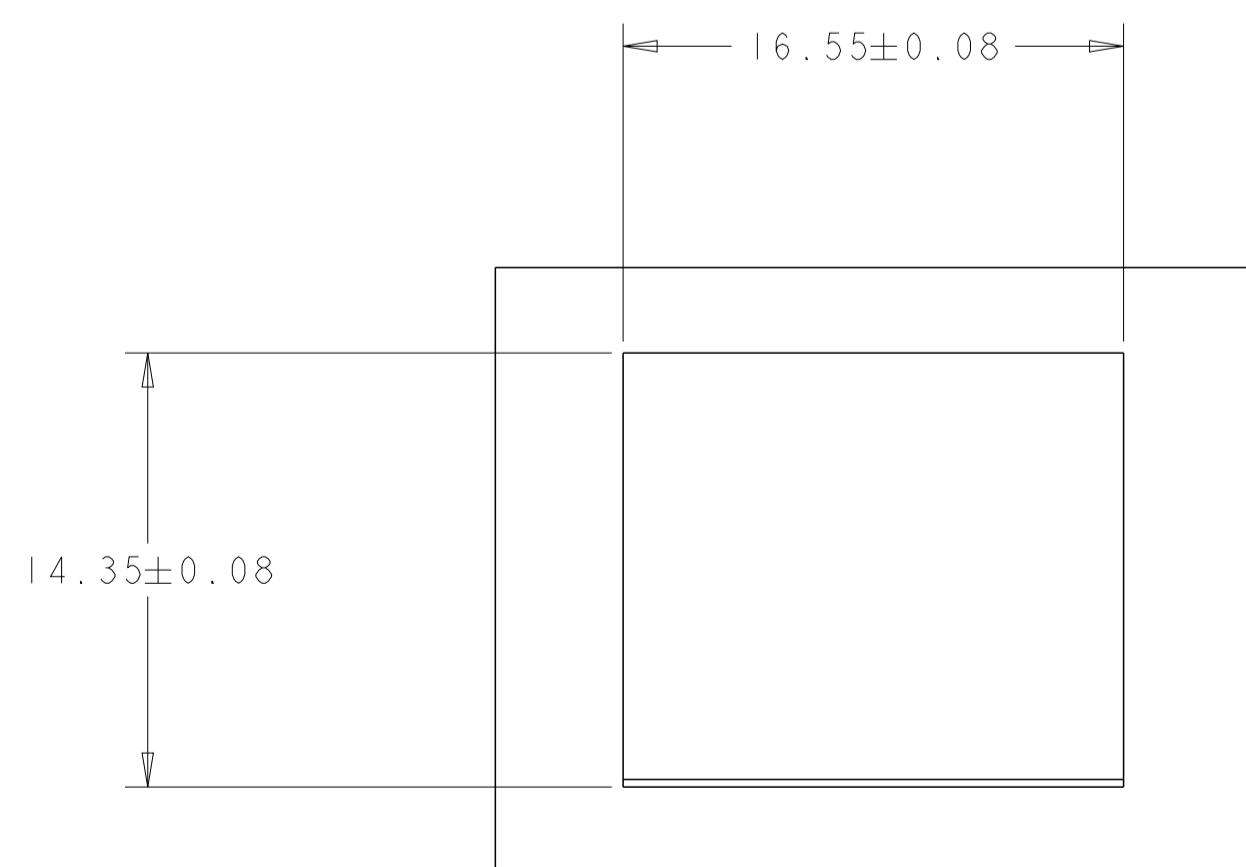

SUGGESTED PANEL CUTOUT SCALE 4:1

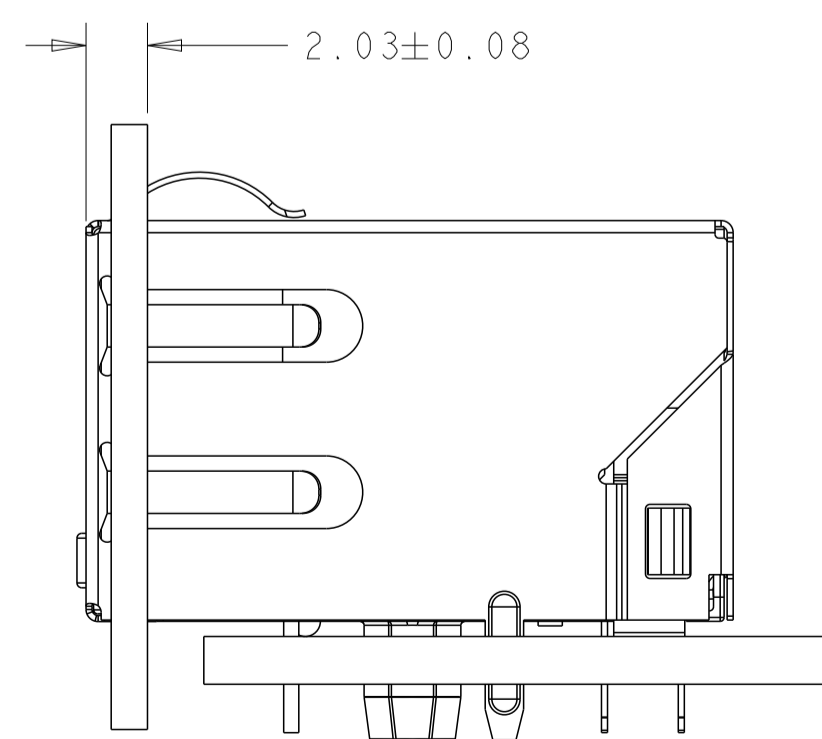

### 4G17P1 GIGABIT CIRCUIT

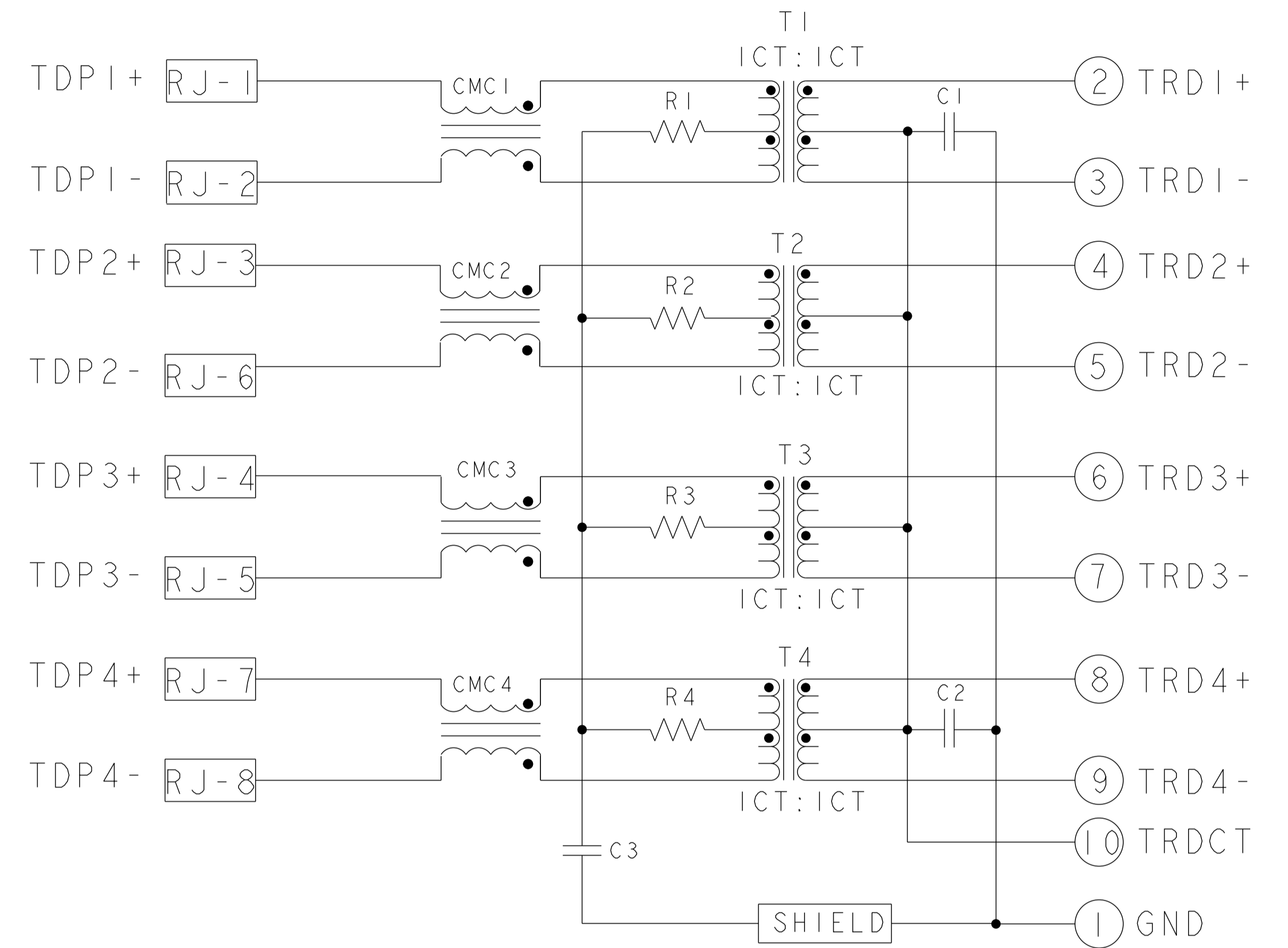

C1-C2= 10nF, 50V, DECOUPLING CAP  
 C3= 1000pF, 2kV, CAPACITORS  
 R1-R4= 75 Ohms, RESISTORS

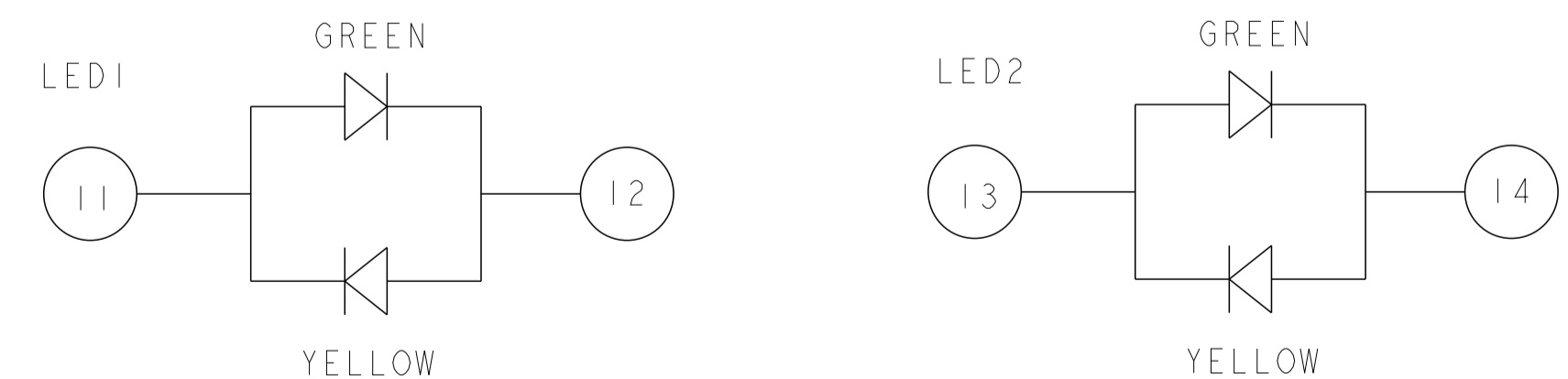

THIS DRAWING IS A CONTROLLED DOCUMENT.		OWN: WILLIAN XIAO 28APR2010		DONGGUAN CHINA
		CHK: TOWER YU 28APR2010		
DIMENSIONS: mm		APVD: MEI TH ZHU 28APR2010	MODEL NAME: MAGJACK	
TOLERANCES UNLESS OTHERWISE SPECIFIED:		DESC: IXL1 4G17P1 GIGABIT TAB DOWN W/ LED		
0 PLC	$\pm 0.25$	SIZE: A1		
1 PLC	$\pm 0.25$	CAGE CODE: 1840490		
2 PLC	$\pm 0.25$	DRAWING NO: 108-104004		
3 PLC	$\pm 0.25$	SCALE: 4:1		
4 PLC	$\pm 0.25$	SHEET 2 OF 2		
ANGLES	$\pm 0.25$	REV: C		
APPLICATION SPEC	-	CUSTOMER DRAWING		