

DATA CONTAINED ON THIS DOCUMENT IS PROPRIETARY TO TROMPETER ELECTRONICS, INC. AND SHALL NOT BE DISCLOSED, COPIED OR USED FOR REPRODUCTION OR MANUFACTURE WITHOUT EXPRESS WRITTEN PERMISSION.

REV		ED		DESCRIPTION	DWN	APPROVED	DATE
				ADDED -12-01 THRU -17-008, -112-01 THRU -117-008, -812-01 THRU -817-008 AND ITEM 16 TO BOM FOR SST WITH D-LUG B-3265-1			
F	13	357		UPGRADE TO LARGER FORMAT, UPGRADE TABLE 1 AND 2; ADDED VIEW FOR SST ROPE & D-LUG; CHANGED NOTE 4; SG ±.03 WAS .500 ±.030; GENERAL UPDATE; SEE ECO	DKC		10/19

DASH NO	DESCRIPTION
-1	CAP (NO CHAIN)
-2	CAP WITH 2.5 BRASS CHAIN
-3	CAP WITH 2.5 NYLON CHAIN
-4	CAP WITH 3.0 BRASS CHAIN
-5	CAP WITH 3.0 NYLON CHAIN
-6	CAP WITH 6.0 BRASS CHAIN
-7	CAP WITH 6.0 NYLON CHAIN
-8	CAP WITH 4.0 BRASS CHAIN
-9	CAP WITH 4.0 NYLON CHAIN
-10	CAP WITH 10.0 BRASS CHAIN
-11	CAP WITH 10.0 NYLON CHAIN
-12	CAP WITH 2.5 INCH SST ROPE
-13	CAP WITH 3.0 INCH SST ROPE
-14	CAP WITH 6.0 INCH SST ROPE
-15	CAP WITH 4.0 INCH SST ROPE
-16	CAP WITH 7.0 INCH SST ROPE
-17	CAP WITH 4.5 INCH SST ROPE

MODEL NO	TYPE
RFI85	2-LUG
RFI853	3-LUG
RFI385	THREAD

DASH NO	"A" DIA	"B" DIA	"C" DIM	"D" DIM
-D1	.755	.875	1.191	.513
-D2	.630	.750	1.066	.450
-D3	.505	.625	.941	.388
-D4	.439	.562	.878	.355
-D5	.380	.500	.816	.325
-D6	.317	.437	.753	.295
-D7	.281	.406	.722	.278
-D8	.610	.750	1.066	.450
-D9	.567	.687	1.003	.419
-DD8	.330	.450	.766	.300
-D10	.192	.312	.628	.231

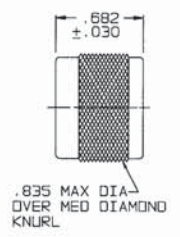

RFI385-1
SHOWN
NO CHAIN/ROPE
OR MOUNTING LUG

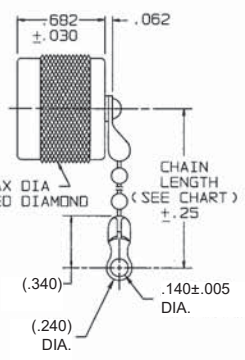

RFI385-2 THRU
-10 SHOWN
STANDARD CHAIN &
MOUNTING LUG

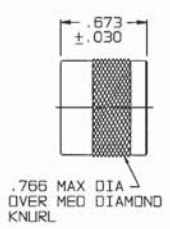

RFI85/
RFI853-1
SHOWN
NO CHAIN/ROPE
OR MOUNTING LUG

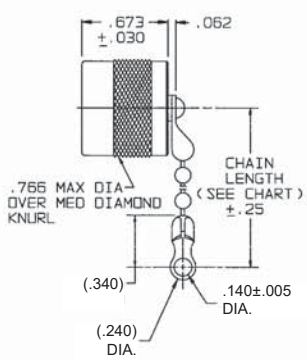

RFI85/RFI853-2 THRU
-11 SHOWN
STANDARD CHAIN &
MOUNTING LUG

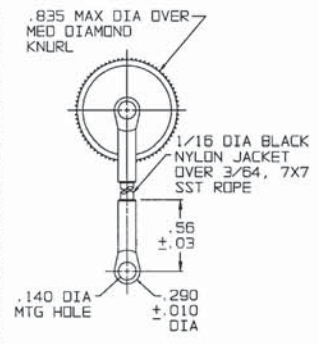

RFI385-12 THRU
-17 SHOWN
STAINLESS STEEL ROPE
AND MOUNTING LUG

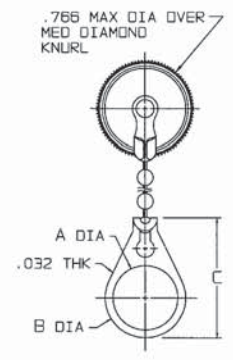

RFI85/RFI853-2-01
THRU -11-008 SHOWN
STANDARD CHAIN AND
BULKHEAD JACK
MOUNTING LUG

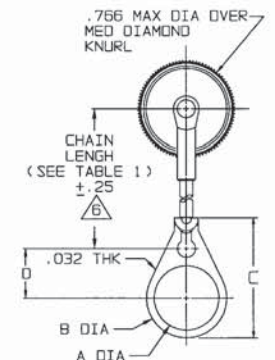

RFI85/RFI853-12-01
THRU -17-008 SHOWN
SST ROPE AND BULKHEAD
JACK MOUNTING LUG

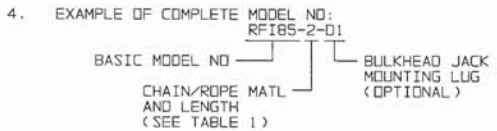

- MALE "C" STYLE DUST CAP
- FINISH: NICKEL
- ALL DIM ARE IN INCHES

QTY	DESCRIPTION	PART NUMBER	ITEM
TOL. UNLESS SPECIFIED			
.100 ±			
.0005 ±			
ANGLES			
DWN	CHK	DATE	REV
14949	3-21-00	11-14-73	F
SCALE 2/1	DATE 11-14-73	SHEET 1C	