

DASH NO	CABLES ACCOMMODATED	A DIM	B DIM	C FLATS	D FLATS	E DIA	ASSEMBLE PER										
-7	TRC-50-2 TRC-75-2	1.135	.096	.438	.438	.500	TAI-189										
-8	8227, BELDEN	1.716	.130	.625	.688	.750	TAI-103										
-9	TWC-78-2 TWC-124-2	1.135	.096	.438	.438	.500	TAI-102										
-A9	BL782, TIMES BL982, TIMES BL1242, TIMES																
-10	RG-22 754E, AT&T																
-11	760A, AT&T	1.716	.130	.625	.688	.750	TAI-103										
-12	16 PEVL, AT&T V1-AL, GENERAL						TAI-128										
-13	TRF-59, TIMES						TAI-129										
-13A	8232, BELDEN						TAI-165										
-14	8233, BELDEN	1.135	.096	.438	.438	.500	TAI-129										
-23	250-3884, MICRODOT						TAI-189										
-24	202-3934, MICRODOT						TAI-102										
-24A	9530A5117, RAYCHEM						TAI-189										
-25	T-43M, GENERAL						TAI-102										
-25A	5021HS331, RAYCHEM						TAI-189										
-26	7028A5518, RAYCHEM						1.135	.096	.438	.438	.500	TAI-102					
-27	T19TPSJ2619EN, WOVEN 202-3927, MICRODOT 202-3942, MICRODOT											TAI-102					
-29	TWC-78-1/TWC-124-1A											TAI-189					
-30	761A, AT&T 8441, BELDEN						1.716	.130	.625	.688	.750	TAI-103					
-32	TRC-50-1											1.135	.096	.438	.438	.500	TAI-189
-33	TRC-75-1																
-42	21-204, ESSEX 4463, CONSOLIDATED											1.135	.096	.438	.438	.500	TAI-102
-43	250-4044/250-4045 293-3930, MICRODOT																
-45	M27500-22TE2T14 1100-66F, STANDARD																
-46	9860, BELDEN	1.716	.130	.625	.688	.750						TAI-103					
-47	M17/176-00002	1.135	.096	.438	.438	.500						TAI-102					
-49	TWAC-78-1F2	1.716	.130	.625	.688	.750						TAI-102					
-54	89207, BELDEN	1.135	.096	.438	.438	.500						TAI-189					
-55	89272, BELDEN						TAI-102										
-56	GC875GC1, GRUMMAN						TAI-189										
-57	GC875GB1, GRUMMAN						TAI-102										
-58	GC875TM24H, GRUMMAN						TAI-189										
-59	GC875LN1, GRUMMAN	1.135	.096	.438	.438	.500	TAI-102										
-60	M17/177, THERMATICS 380-10045, BOEING						TAI-189										
-64	7528A5314, RAYCHEM																

DATA CONTAINED IN THIS DOCUMENT IS PROPRIETARY TO TROMPETER ELECTRONICS, INC. AND SHALL NOT BE DISCLOSED, COPIED OR USED FOR PROCUREMENT OR MANUFACTURE WITHOUT EXPRESS WRITTEN PERMISSION OF TROMPETER ELECTRONICS, INC.

REVISIONS		310-0025	SH 1
REV	DESCRIPTION	DATE	APPROVED
U	REVISED PER ECO 14778	11-5-02	RM

CABLE ENTRY			
DASH NO	DIA	DASH NO	DIA
-7	.274	-29	.191
-8	.345	-30	.235
-9	.285	-32	.191
-A9		-33	.217
-10	.455	-42	.300
-11	.347	-43	.200
-12	.495	-45	.183
-13	.362	-46	.475
-13A	.352	-47	.164
-14	.490	-49	.132
-23	.183	-54	.323
-24	.191	-55	.250
-24A	.200	-56	.191
-25	.285	-57	
-25A		-58	.198
-26	.191	-59	
-27	.145	-60	.217
		-64	.183

FIG 1  
-9 SHOWN

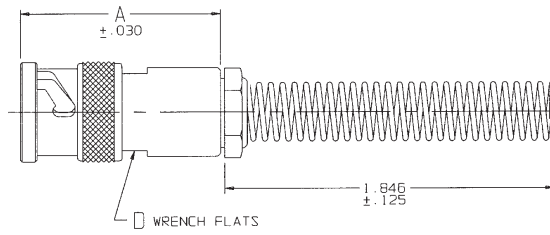
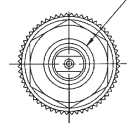
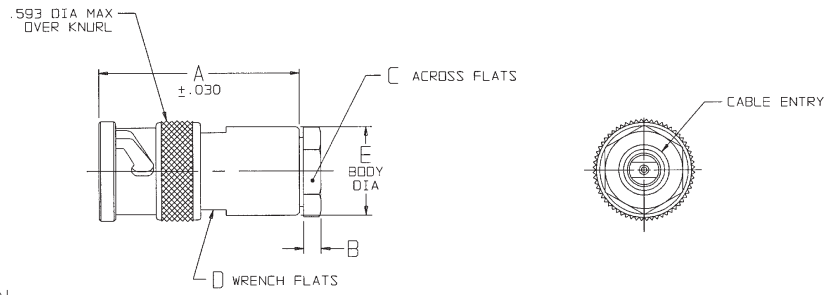

FIG 2  
-9 SHOWN



RED INDICATES ORIGINAL

6. EXAMPLE OF A COMPLETE MODEL NO.

PL74 -47

BASIC MODEL NO. | DASH NO.

IF BEND RELIEF SPRING REQD (SEE FIG 1)  
ADD SUFFIX "BR" TO MODEL NO  
(NOT AVAILABLE WITH CABLE GROUPS -8, -10, -11,  
-12, -13, -13A, -14, -46 & -54)

CLAMP NUT OMITTED  
2-LUG BAYONET CONCENTRIC TWINAX/TRIAX TRB CABLE PLUG

FINISH: TFS-1A (NICKEL)

ALL DIM ARE IN INCHES

TYPE	DASH NO/CABLE GROUP																
TWINAX	-8	-9	-A9	-10	-11	-12	-24	-25	-27	-29	-30	-45	-46	-47	-49	-54	-55
TRIAx	-7	-13	-13A	-14	-23	-24A	-25A	-26	-32	-33	-42	-43	-56	-57	-59	-60	-64
QUADRAx	-58																

INTERPRET DIMING PER MIL-STD-100 DIMENSIONS ARE IN INCHES UNLESS FINISH INDICATED UNLESS OTHERWISE SPECIFIED	TOL. UNLESS SPECIFIED .XX .XXX ± .005 .XXXX ± .0005 ANGLE(S)		<b>TITLE:</b> PL74/PL74BR
DATE: 11-4-02	MATERIAL:		
11-4-02	11-4-02	<b>SIZE:</b> CAGE CODE <b>B 14949</b>	<b>DRAWING NO:</b> 310-0025
305-0515	310-0025	<b>SCALE:</b> NONE	<b>DATE:</b> 3/27/78
NEXT ASSY	310-0025U	<b>DD NOT SCALE DIMS</b>	<b>SHEET:</b> 1C