

DATE	REV.	ECN	APP'D BY
2-17-15	A4	10258	ADB
2-19-16	A5	10554	TRM

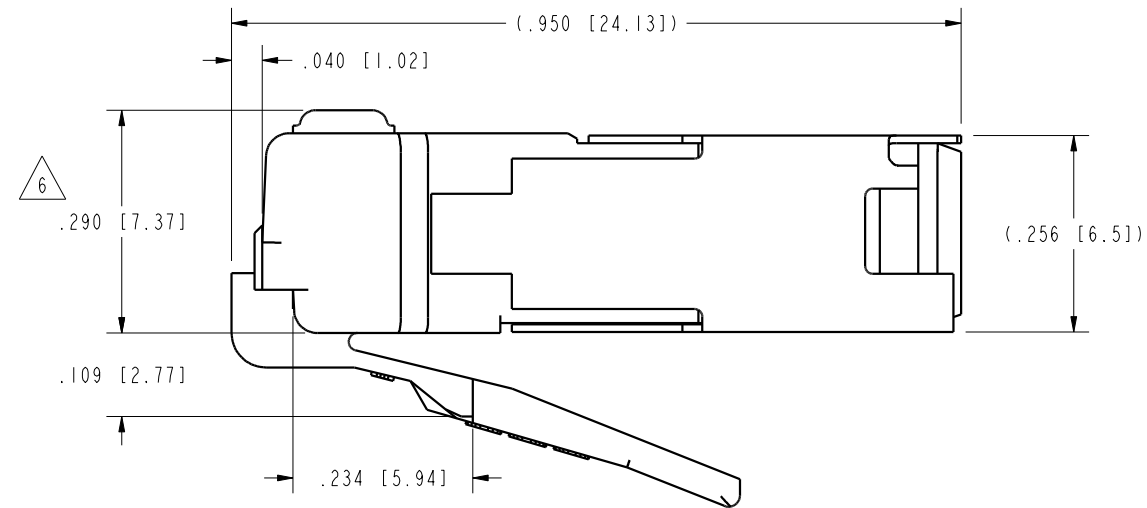
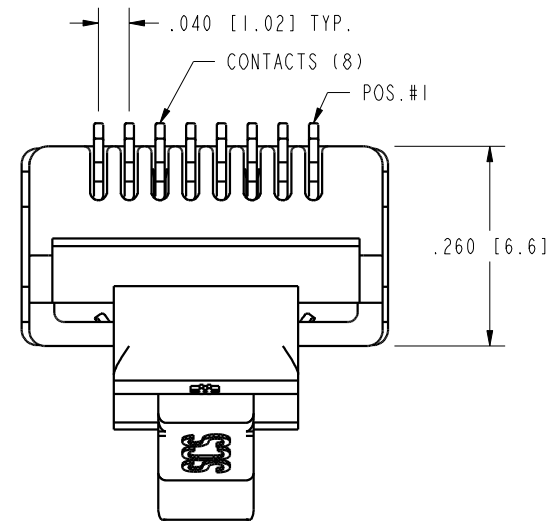
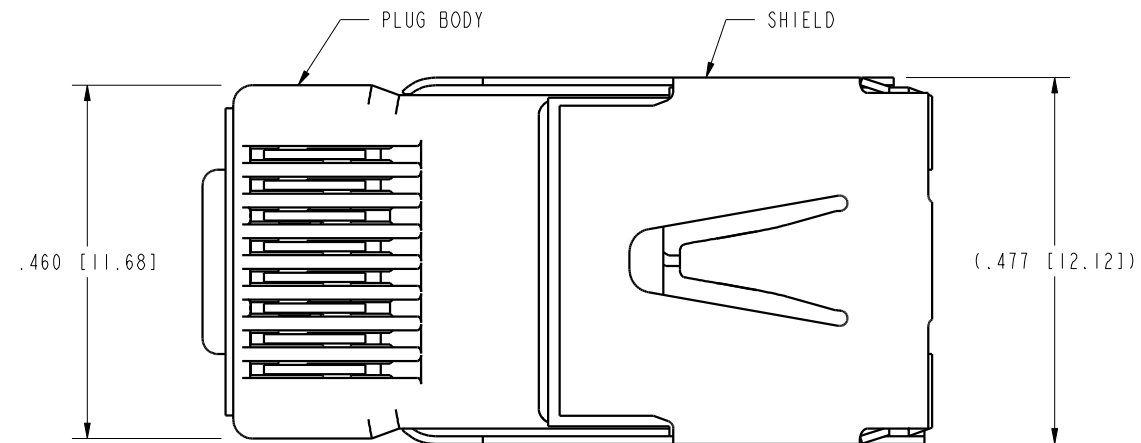
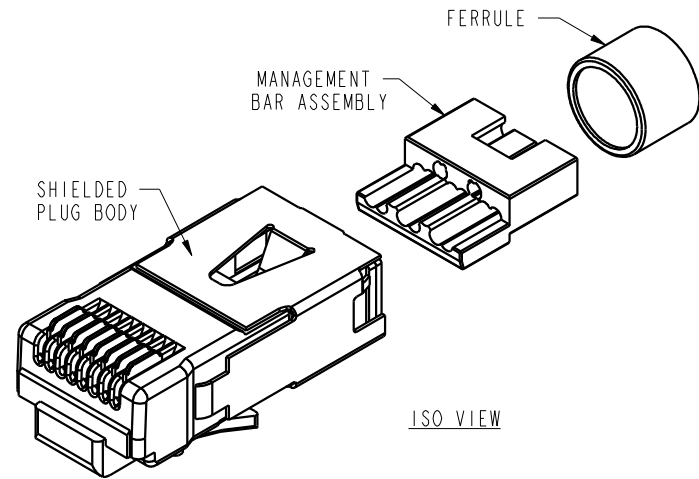

NOTES:

1. PLUG KIT CONSISTS OF:  
PRE-INSERTED PLUG BODY & SHIELD  
MANAGEMENT BAR ASSEMBLY  
FERRULE
2. MATERIALS:  
PLUG BODY: CLEAR POLYCARBONATE, UL 94-V0  
MANAGEMENT BAR: CLEAR POLYCARBONATE, UL 94-V0  
CHANNEL COMPENSATOR: NICKEL PLATED BRASS  
SHIELD: TIN PLATED BRASS  
CONTACTS: COPPER ALLOY, SELECTIVE GOLD PLATING  
FERRULE: NICKEL OR TIN PLATED BRASS
3. CONTACTS TERMINATE SOLID OR STRANDED CONDUCTORS UP TO .037 [0.94] OUTSIDE DIAMETER OF INSULATION.
4. FOR PRODUCT SPECIFICATION SEE PRO26-01.
5. DIMENSIONS AND TOLERANCES COMPLY WITH TIA-1096 STANDARD.
6. TERMINATED PLUG HEIGHT: .237 [6.02] ±.005 [0.13] ON CABLE.
7. DESIGNED FOR CATEGORY 6 APPLICATIONS.

BULK	50 MICRO-INCHES [1.27um]	SS-39200-007
PACKAGE	CONTACT PLATING IN MATING AREA	PART NUMBER

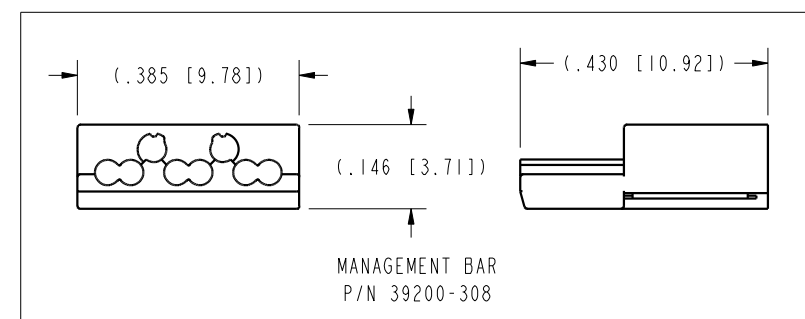
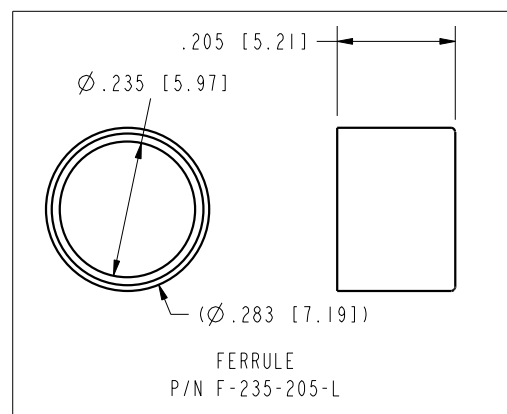

THIRD ANGLE PROJECTION

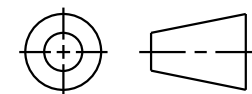

11118 Susquehanna Trail South  
Glen Rock, PA 17327-9199  
(717) 235-7512  
<http://www.stewartconnector.com>

DO NOT SCALE DRAWING

DRAWING IS SUBJECT TO CHANGE WITHOUT NOTICE

DIMENSIONS: INCHES [METRIC]

UNLESS OTHERWISE SPECIFIED TOLERANCES ARE ±.005 [0.13] ANGLES ARE ±1°

SHEET NO. 1 OF 1

8 x 8 CATEGORY 6 SHIELDED PLUG ASSEMBLY WITH MANAGEMENT BAR & FERRULE

THIS DRAWING AND THE SUBJECT MATTER SHOWN THEREON ARE CONFIDENTIAL AND THE PROPRIETARY PROPERTY OF STEWART CONNECTOR AND SHALL NOT BE REPRODUCED, COPIED, OR USED IN ANY MANNER WITHOUT PRIOR WRITTEN CONSENT OF STEWART CONNECTOR. ONE OR MORE U.S. PATENTS MAY APPLY TO THIS PRODUCT. FOR DETAILS, PLEASE VISIT: [HTTP://BELFUSE.COM/STEWART/STEWART\\_PATENTS/](http://BELFUSE.COM/STEWART/STEWART_PATENTS/)

DRN BY:	DB	DATE	1-9-02
APPD BY:	RGC	DATE	1-9-02
DWG. NO.	CT390013	REV.	A5