

THE INFORMATION CONTAINED HEREIN IS CONSIDERED "PROPRIETARY" TO BEL FUSE INC. AND SHALL NOT BE COPIED, REPRODUCED OR DISCLOSED WITHOUT THE WRITTEN APPROVAL OF BEL FUSE INC.



**ELECTRICAL CHARACTERISTICS @ 25°C**

- TURNS RATIO**
- TP1 1CT : 1CT ±2%
  - TP2 1CT : 1CT ±2%
  - TP3 1CT : 1CT ±2%
  - TP4 1CT : 1CT ±2%
- DCL @ 100kHz/100mVRMS**  
(-40°C - +85°C)
- 180µH MIN.
  - 120µH MIN.
- 19mA DC BIAS (-40°C - +85°C)**
- INS. LOSS -0.004<(fMHZ)>-0.4 dB MAX
  - 1MHZ TO 150MHZ
- RET. LOSS**
- 1MHZ-40MHZ -20 dB MIN
  - 40.1MHZ-150MHZ -20+15LOG<(f/40MHZ)> dB MIN
- CROSSTALK**
- 1MHZ - 40MHZ -35 dB MIN
  - 40MHZ-150MHZ -35+15LOG<(f/40MHZ)> dB MIN
- CM TO CM REJ**
- 1MHZ - 150MHZ -25 dB MIN
- HIPOT (Isolation Voltage): 2250 VDC**
- 100% OF PRODUCTION TESTED TO COMPLY WITH IEEE 802.3 ISOLATION REQUIREMENTS.
- NOTE: PORT-TO-PORT ISOLATION NOT INCLUDED.**
- BALANCED DC LINE CURRENT** 600mA MAX. CONTINUOUS  
1.2A MAX. FOR 200 MILLISECONDS
- OPERATING TEMPERATURE:** -40°C TO +85°C

**SCHEMATIC**

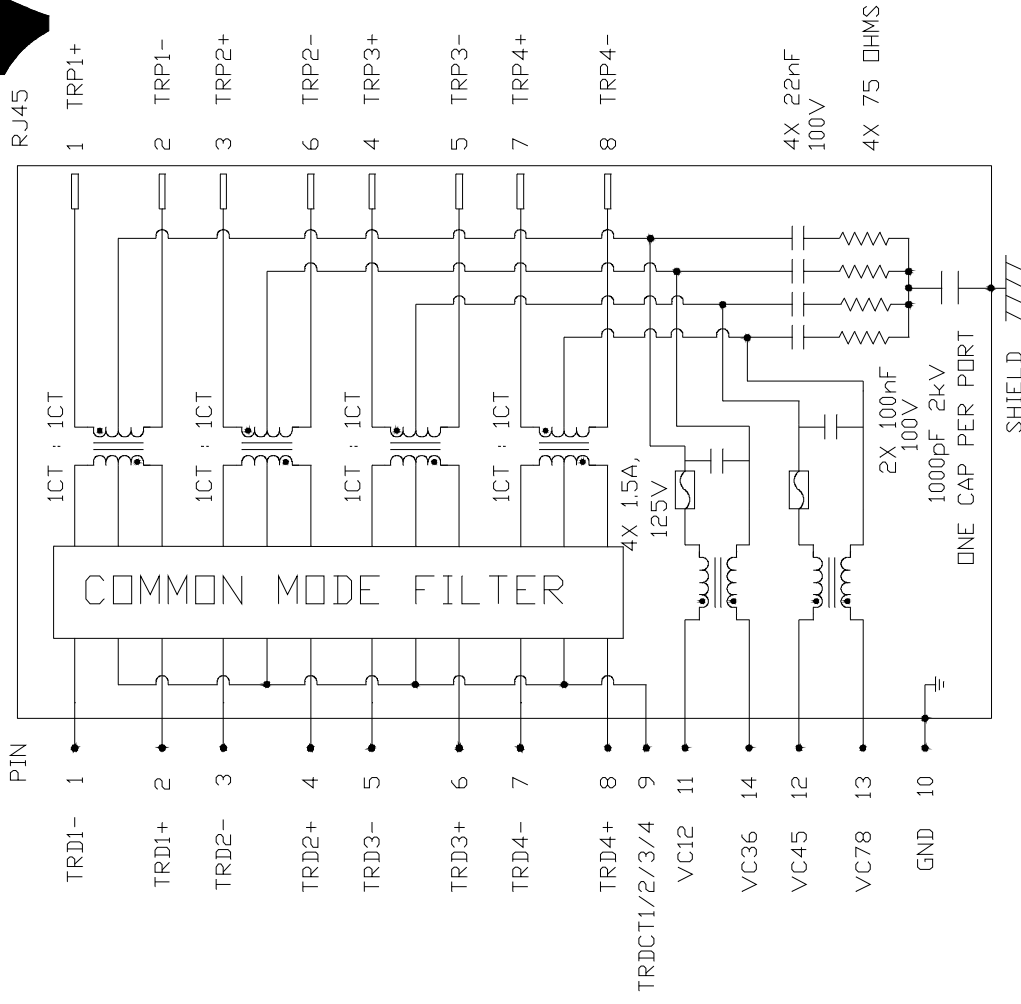

<b>ORIGINATED BY</b> CHOW WANCHUNG	<b>TITLE</b> 2X2 2.5 Gigabit MagJack® 4PPoE(EXTENDED TEMPERATURE)
<b>DATE</b> 2019-07-19	
<b>DRAWN BY</b> XIE YIMING	0854-2X2J-JDB-F PATENTED
<b>DATE</b> 2019-07-19	

<b>PART NO. / DRAWING NO.</b> 08542X2JJDBF	<b>STANDARD DIM.</b> TOL. IN INCH
<b>FILE NAME</b> 08542X2JJDBF_A.DWG	[ ] METRIC DIM. AS REF.
	UNIT : INCH [mm]
	SCALE : N/A
	SIZE : A4

REV. : A PAGE : 2

**MAGNETIC SOLUTIONS**  
a bel group

THE INFORMATION CONTAINED HEREIN IS CONSIDERED "PROPRIETARY" TO BEL FUSE INC. AND SHALL NOT BE COPIED, REPRODUCED OR DISCLOSED WITHOUT THE WRITTEN APPROVAL OF BEL FUSE INC.

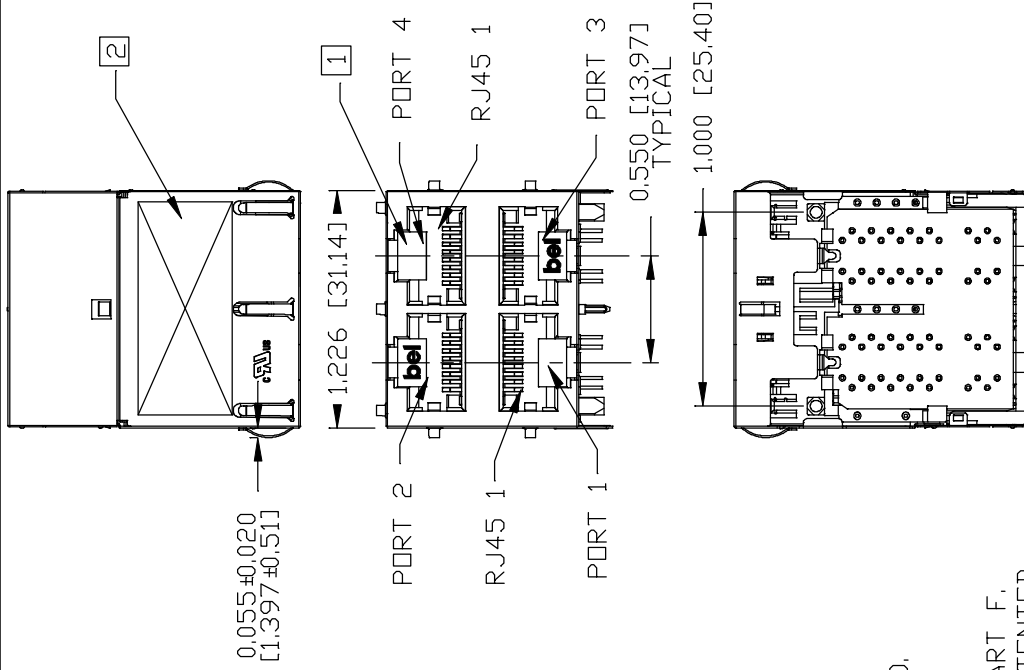
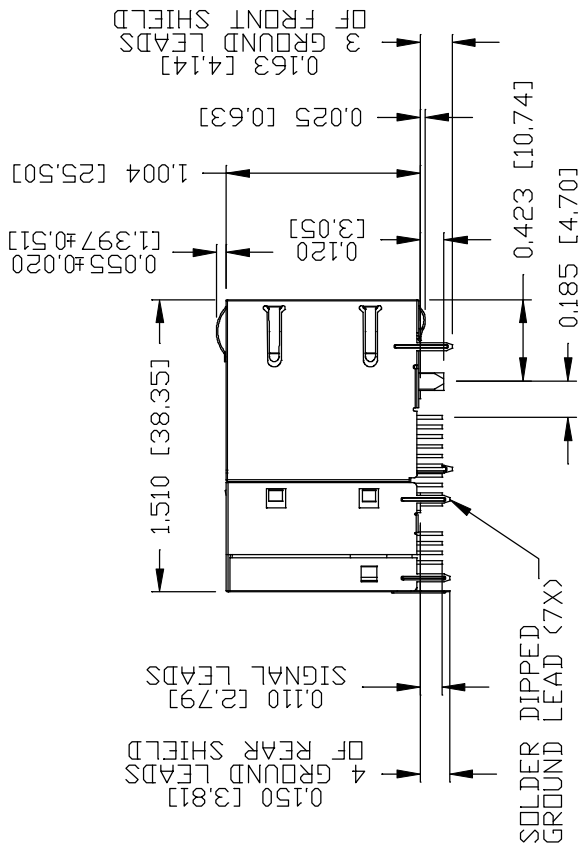

**NOTES:**

1. PLASTIC HOUSING: THERMOPLASTIC PBT, BLACK

2. CONTACT PLATING: 50 MICRO-INCH HARD GOLD PLATING OR EQUIVALENT.

3. OUTPUT PINS: TIN-COATED COPPER WIRE, DIA 0.018 INCH.

4. METAL SHIELD: 100 MICRO-INCH MIN MATTE TIN. PINS ARE SOLDER DIPPED.

5. JACK CAVITY CONFORMS TO FCC RULES AND REGULATIONS, PART 68 SUBPART F.

6. MARK PART WITH MFG LOGO, MFG NAME, PART NUMBER, DATE CODE AND PATENTED

7. THE PRODUCT IS RoHS COMPLIANT.

8. THE PRODUCT IS PATENTED. THE PATENT NUMBER ARE U.S. PAT. 6,840,817 AND U.S. PAT. 7,123,117.

9. THE PART IS RECOMMENDED FOR WAVE SOLDERING. THE SUGGESTED PEAK WAVE SOLDERING CONDITION IS 260°C MAX AND 10 SECONDS MAX.

10. **RoHS** us UL RECOGNIZED - FILE #E196366 AND E169987.

11. THE PRODUCT IS PATENTED. THE PATENT NUMBER ARE U.S. PAT. 6,840,817 AND U.S. PAT. 7,123,117.

<b>ORIGINATED BY</b> SANDY LIN	<b>PART NO. / DRAWING NO.</b> 08542X2JJDDBF	<b>STANDARD DIM.</b> TOL. IN INCH	<b>[ ] METRIC DIM.</b> AS REF.
<b>DATE</b> 2019-07-19	<b>FILE NAME</b> 08542X2JJDDBF_A.DWG	<b>.X</b>	<b>UNIT : INCH [mm]</b>
<b>DRAWN BY</b> RUAN WENJUN	<b>PATENTED</b>	<b>.XX</b>	<b>SCALE : N/A</b>
<b>DATE</b> 2019-07-19		<b>.XXX</b>	<b>SIZE : A4</b>

This document is electronically generated. This is a controlled copy if used internally



THE INFORMATION CONTAINED HEREIN IS CONSIDERED "PROPRIETARY" TO BEL FUSE INC. AND SHALL NOT BE COPIED, REPRODUCED OR DISCLOSED WITHOUT THE WRITTEN APPROVAL OF BEL FUSE INC.

RoHS



LOWER DECK  
UPPER DECK

PORT ASSIGNMENT  
(COMPONENT SIDE VIEW)

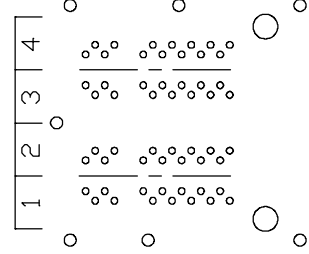
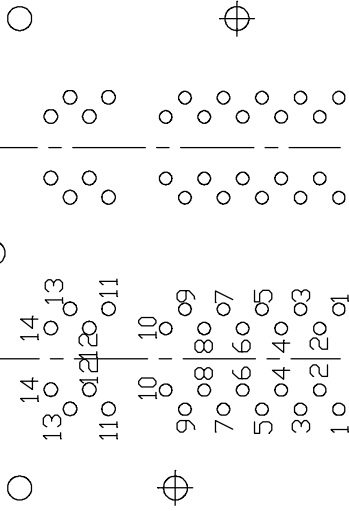

1.551 [39.40]  
0.530 [13.46]  
0.425 [10.79]

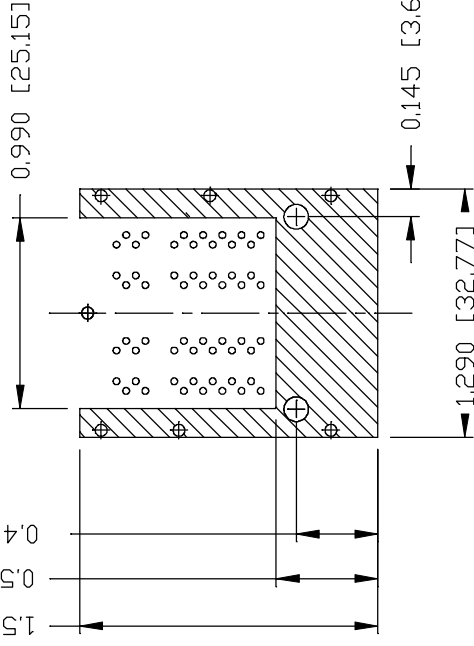

PIN-OUT INFORMATION  
(COMPONENT SIDE VIEW)

14	VC36
13	VC78
12	VC45
11	VC12
10	GND
9	TRDCT1/2/3/4
8	TRD 4+
7	TRD 4-
6	TRD 3+
5	TRD 3-
4	TRD 2+
3	TRD 2-
2	TRD 1+
1	TRD 1-

THE SHADED AREA ON THE CUSTOMER BOARD ARE RECOMMENDED TO BE CLEAR OFF ANY VIA HOLE OR COMPONENT PAD.

REV. : A	PAGE : 4
STANDARD DIM. [ ] METRIC DIM. AS REF.	TOL. IN INCH
.X	UNIT : INCH [mm]
.XX	SCALE : N/A
.XXX ±0.004	SIZE : A4
PART NO. / DRAWING NO.	08542X2JJDBF
FILE NAME	08542X2JJDBF_A.DWG
TITLE	2X2 2.5 Gigabit MagJack® 4PpoE(EXTENDED TEMPERATURE) 0854-2X2J-JDB-F PATENTED
ORIGINATED BY	SANDY LIN
DATE	2019-07-19
DRAWN BY	RUAN WENJUN
DATE	2019-07-19

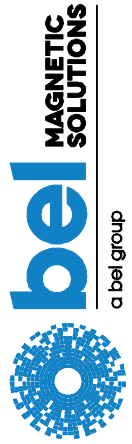

a bel group

This document is electronically generated. This is a controlled copy if used internally

PC002(2)120214

THE INFORMATION CONTAINED HEREIN IS CONSIDERED "PROPRIETARY" TO BEL FUSE INC. AND SHALL NOT BE COPIED, REPRODUCED OR DISCLOSED WITHOUT THE WRITTEN APPROVAL OF BEL FUSE INC.

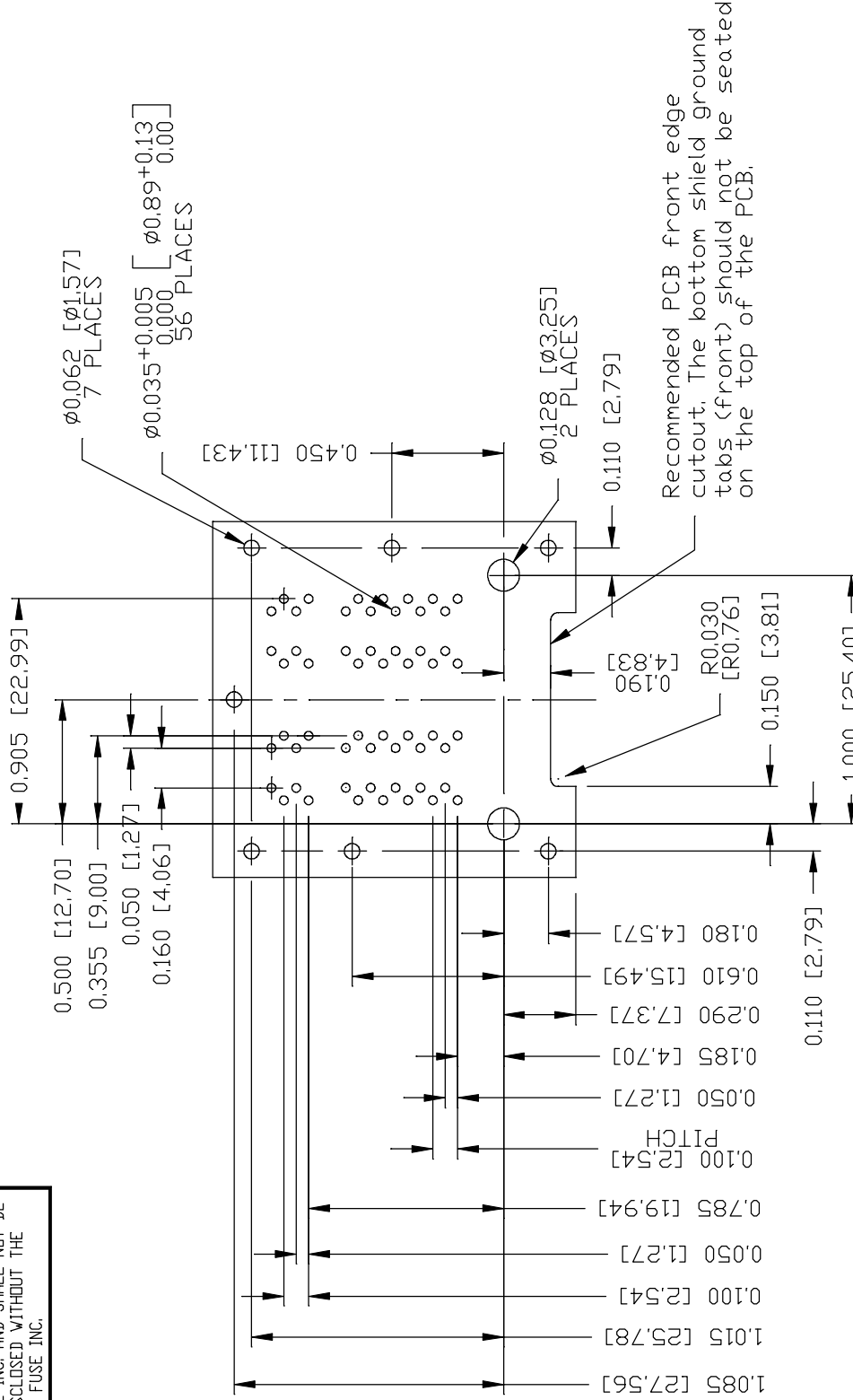

SUGGESTED FOOTPRINT  
 (COMPONENT SIDE VIEW)

REV. : A		PAGE : 5	
ORIGINATED BY SANDY LIN		PART NO. / DRAWING NO. 08542X2JJDBF	
DATE 2019-07-19		STANDARD DIM. TOL. IN INCH	
DRAWN BY RUAN WENJUN		[ ] METRIC DIM. AS REF.	
DATE 2019-07-19		UNIT : INCH [mm]	
TITLE 2X2 2.5G gigabit MagJack® 4PPoE(EXTENDED TEMPERATURE) 0854-2X2J-JDB-F PATENTED		SCALE : N/A	
		.XXX ±0.004	
		SIZE : A4	

This document is electronically generated. This is a controlled copy if used internally



MAGNETIC SOLUTIONS  
 a bel group

THE INFORMATION CONTAINED HEREIN IS CONSIDERED "PROPRIETARY" TO BEL FUSE INC. AND SHALL NOT BE COPIED, REPRODUCED OR DISCLOSED WITHOUT THE WRITTEN APPROVAL OF BEL FUSE INC.



SUGGESTED PANEL OPENING.

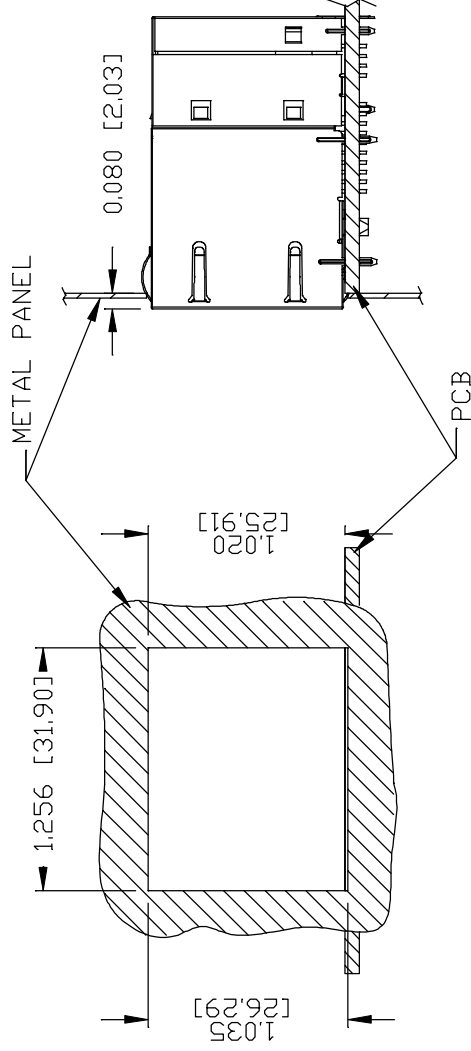

NOTE:

THE DISTANCE OF PANEL INSIDE SURFACE RELATIVE TO FRONT SURFACE OF PART IS ONLY A SUGGESTION, IN CASE THIS DISTANCE IS DIFFERENT, THE REQUIRED PANEL OPENING DIMENSIONS CHANGE ACCORDINGLY.

PACKING INFORMATION

PACKING TRAY : 0200M9999-H0 (TOP)  
0200M9999-H1 (BOTTOM)

PACKING QUANTITY : 32 PCS FINISHED GOODS PER TRAY

7 TRAYS (224 PCS FINISHED GOODS) PER CARTON BOX

NOTE : CARDBOARDS ARE PLACED BETWEEN LAYERS OF PACKING TRAY INSIDE CARTON BOX  
(INCLUDE THE UPPERMOST AND LOWERMOST TRAY)

REV. : A		PAGE : 6	
<b>ORIGINATED BY</b> SANDY LIN <b>DATE</b> 2019-07-19 <b>DRAWN BY</b> RUAN WENJUN <b>DATE</b> 2019-07-19		<b>TITLE</b> 2X2 2.5 Gigabit MagJack® 4PPOE(EXTENDED TEMPERATURE) 0854-2X2J-JDB-F PATENTED	
<b>PART NO. / DRAWING NO.</b> 08542X2JJDBF <b>FILE NAME</b> 08542X2JJDBF_A.DWG		<b>STANDARD DIM.</b> TOL. IN INCH .X .XX .XXX ±0.005	
<b>UNIT : INCH [mm]</b> SCALE : N/A		<b>[ ] METRIC DIM.</b> AS REF. <b>SIZE : A4</b>	

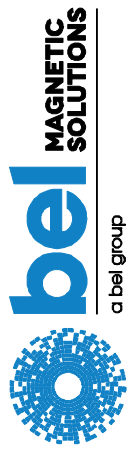

This document is electronically generated. This is a controlled copy if used internally